

Dengue Ns1 Ag & IgG/IgM Combo Test Kit Rapid 15-Minute Diagnostic Test with 98% Accuracy

Our Product Introduction

For more products please visit us on oxygenconcentratormedical.com

Basic Information

- Place of Origin: china
- Brand Name: DVOT
- Certification: CE/ISO
- Model Number: Dengue Ns1 Ag & IgG/IgM Combo Test Kit
- Minimum Order Quantity: 360 test
- Price: 0.9-1 USD
- Packaging Details: 360T/PER CTN Weight :11KGS CTN SIZE :46*44*44CM
- Delivery Time: 15-20 work days
- Payment Terms: D/P, T/T, Western Union, MoneyGram
- Supply Ability: 1000000pcs



Product Specification

- Result Time: 15 Minutes To Get
- Time Of Use: Disposable
- Certifications: CE ISO
- Keyword: Antigen Rapid Test
- Accuracy: 98%
- Test Time: 15 Minutes
- Type: Rapid Test Kit
- Highlight: ce clungene antigen rapid test, ce medical diagnostic test kits, disposable clungene antigen rapid test



More Images



Product Description

Dengue Ns1 Ag & IgG/IgM Combo Test Kit Rapid 15-Minute Diagnostic Test with 98% Accuracy

Product Description:

Dengue fever is an acute insect-borne infectious disease caused by dengue virus, which is mainly transmitted by *Aedes aegypti* and *Aedes albopictus* mosquitoes. The incubation period of dengue fever is usually 1-14 days, mostly 5-9 days. Patients usually have an acute onset of illness, with the first symptom being sudden onset of high fever, which may be accompanied by chills, and a temperature of up to 40°C within 24 hours. It usually lasts for 3~7 days. In some patients, the temperature may drop to normal after 3-5 days of fever, but rise again after 1 day, a phenomenon known as bimodal or saddle fever.

Severe headache, eye pain, muscle pain and bone and joint pain, malaise, nausea, vomiting, and gastrointestinal symptoms such as poor appetite, abdominal pain and diarrhea can be present at the beginning of the fever. If you are not sure whether you are infected with dengue virus, you can use this antigen test.

With an accuracy rate of 98%, you can trust the results of this Medical Diagnostic Test Kit. It has been certified by CE and ISO, ensuring that it meets the highest standards of quality and reliability.

The Time Of Use for this Medical Diagnostic Test Kit is disposable, making it a convenient and safe option for testing. It is a reliable way to detect the presence of the COVID19 virus quickly and accurately, making it an essential tool in the fight against the pandemic.

Technical Parameters:

Time of Use	Disposable
Accuracy	98%
Test Time	15 Minutes
Type	Rapid Test Kit
Result Time	15 Minutes to get
Certifications	CE, ISO
Keyword	Antigen Rapid Test
Other possible keywords	Antibody Diagnostic Kit, Antigen Home Test Kit, Antigen Rapid Self Test Kit

Applications:

One of the primary applications of the DVOT test kit is in medical clinics and hospitals. The high accuracy of the kit (98%) makes it a valuable asset in the diagnosis of dengue fever, allowing doctors to quickly and confidently determine whether a patient is infected with the virus. The test kit is also designed to deliver results in just 15 minutes, making it a time-saving solution for busy medical professionals.

Another potential application of the DVOT test kit is in community health settings. The kit's accuracy and speed make it a valuable tool for identifying and tracking outbreaks of dengue fever, especially in areas where the disease is endemic. The test kit's disposable design also makes it a convenient option for use in remote or under-resourced areas, where traditional laboratory testing may not be readily available.

The DVOT test kit is also suitable for use in at-home antigen testing. As the kit delivers results in just 15 minutes, it can be a valuable tool for individuals who suspect they may have been exposed to the dengue virus. The test kit's antigen rapid testing capabilities make it an efficient and reliable option for those who want to monitor their health without the need for a medical professional.

Overall, the DVOT Dengue Ns1 Ag & IgG/IgM Combo Test Kit is a versatile and efficient medical diagnostic tool that can be used in a variety of settings. Whether in medical clinics, community health settings, or for at-home antigen testing, the kit's accuracy, speed, and disposable design make it a valuable asset for detecting and tracking dengue fever outbreaks.

Support and Services:

Our Medical Diagnostic Test Kits are designed to provide accurate and reliable results for a variety of medical conditions. Our team is available to assist with any questions or concerns you may have regarding our products.

Steps to use:

Preparation Stage:

Ensure that your hands are clean and that you have the required blood collection kit (e.g., blood collection needle, alcohol pads, etc.). Remove the test card from the box and check that the package is intact and that it is within the expiration date. Follow the instructions on the package to confirm the type of sample and sample size required for the test card.

Collect the blood sample:

Clean the blood collection site (usually the tip of the finger) with an alcohol pad and allow the alcohol to evaporate. Use a blood collection needle to gently prick the tip of the finger and collect the appropriate amount of blood sample. Take care to avoid contaminating the sample.

Perform the test:

Step 1: Add a drop of blood sample to the designated area of the test card.
Step 2: Wait a certain amount of time (usually 15 minutes) according to the instructions so that the test card can respond adequately.
Step 3: After completing the wait, observe the results on the test card.

Read the results:

Observe the indicated areas or lines on the test card and judge the results according to the explanations provided in the instructions. Take care to distinguish between the different results and their significance for Dengue Negative, Dengue Positive and Dengue NS1 Test.



Dvot

DENGUE

Dengue NS1Ag & IgG/IgM Combo Test kit

Dengue fever, also known as breakbone fever, is a mosquito-borne tropical disease caused by the dengue virus. Symptoms include fever, headache, muscle and joint pains, and a characteristic skin rash that is similar to measles.



FEATURE

Accuracy, visual result, simple and safe to use

SPECIMEN

Whole Blood/Serum/Plasma

REACTION TIME

15mins

STORAGE TEMPERATURE

4-30°C

SHELF LIFE

24 months



TEST PROCEDURE

• For serum/plasma sample testing



Dengue NS1 Ag

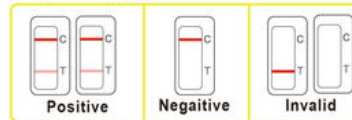

• For whole blood sample testing

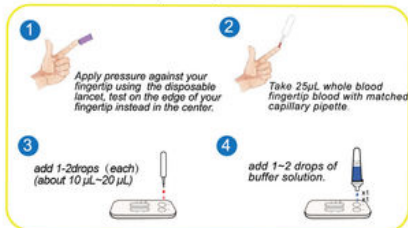

Dengue IgG/IgM

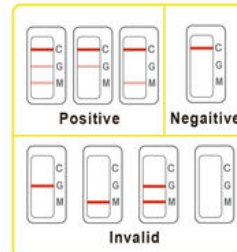

EXCELLENT CLINICAL COMPARISON RESULT

Items	Sensitivity	Specificity
Dengue NS1 Antigen Test	95.8%	96.1%
Dengue IgG/IgM Antibody Test	94.3%	98.3%

The packing details



CB	
QTY :	360 PCS
G.W :	12 KG
MEAS :	46X44X44CM



Shenzhen Emeng Health Technology Co., LTD



+86 13760822077



kaylayi0612@foxmail.com



oxygenconcentratormedical.com

Room D, 7th Floor, Guang Long Building, 162 Ping Xin North Road, PingHu Street, LongGang District, ShenZhen