

9 IN1 Multiplex Respiratory Home Test Kit Antigen Rapid Test for Bunch Order Requirement

Our Product Introduction

for more products please visit us on oxygenconcentratormedical.com

Basic Information

- Place of Origin: China
- Brand Name: DVOT
- Certification: CE/ISO
- Model Number: 9 in1
- Minimum Order Quantity: 360 test
- Price: 2.4USD
- Packaging Details: QTY: 360T/PER CTN; Weight :14KGS; CTN SIZE : 46*44*44CM
- Delivery Time: 15-20 work days
- Payment Terms: D/P, T/T, Western Union, MoneyGram
- Supply Ability: 1000000pcs



Product Specification

- Test Time: 8mins
- Time Of Use: Disposable
- Keyword: Antigen Rapid Test
- Date Of Use: 1.5 Years
- Highlight: **9 IN1 Antigen Rapid Test, Multiplex Respiratory Home Test Kit**



More Images



Product Description

Hot sale Rapid 9 IN1 Multiplex Respiratory Home Test Kit for Bunch Order Requirement

Product Description:

During the first few days of a new coronavirus infection, symptoms are often nonspecific and may include cough, fever, and sore throat. These symptoms can be difficult to distinguish from other viral infections such as influenza, respiratory syncytial virus (RSV) or viruses associated with the common cold.

DOVT's Multiple Respiratory Antigen Test is designed to detect if your symptoms are caused by one of the following viruses: SARS-COV-2 & RSV & MP & ADV & Flu AB & PIV1/3 & PIV2 & HMPV When a combined diagnostic is performed to determine the cause of the disease, the appropriateness of treatment can be determined, and targeted therapy can be administered.

In summary, the Multiplex RespiratoryAntigen Test Kit allows you to quickly determine which infections are causing symptoms and does not require rigorous training, but can be used anywhere, anytime by following the instructions.

Advantage:

- ✓ Get results at home
- ✓ Self-testing made easy
- ✓ Save time
- ✓ Results in 8 minutes
- ✓ Can be stored for a long time
- ✓ Simple testing procedure

Test Time	8mins
Time Of Use	Disposable
Keyword	Antigen Rapid Test
Date of use	1.5 years

Support and Services:

Our medical diagnostic test kits are designed for accuracy and ease of use. We offer technical support services to assist with any questions or issues that may arise during the testing process.

Our goal is to provide our customers with the highest level of support and service to ensure successful testing outcomes.

Infected or not? Test right now!



Multiplex Respiratory Antigen Test Kit

New
Omicron
EG.5.CH.1.1 JN-1
Detected

SARS-CoV-2 | RSV | MP | ADV | Flu A/B | PIV 1/3 | PIV 2 | HMPV

9 In 1



Anterior **Nasal** Swab
Anteriorer Nasenabstrich

SARS-CoV-2 **94.55%**
Sensitivity

Influenza A **90.48%**
Sensitivity

Influenza B **91.67%**
Sensitivity

RSV **93.62%**
Sensitivity



MP **90.82%**
Sensitivity

ADV **91.18%**
Sensitivity

PIV1/3 **92.23%**
Sensitivity

PIV2 **90.20%**
Sensitivity

HMPV **90.6%**
Sensitivity



About the Antigen Combo Test Kit

During the first few days of a Covid-19 illness, symptoms tend to be nonspecific and may include cough, fever and sore throat. These symptoms can be indistinguishable from other viral infections, such as influenza, respiratory syncytial virus (RSV), or viruses associated with the common cold. Because of this, combo diagnostic testing is needed and important, not only to determine the cause of the illness, but also to determine whether treatment is appropriate.

SARS-CoV-2 & RSV & MP & ADV & Flu A/B & PIV1/3 & PIV2 & HMPV Antigen Combo Test Kit is an easy and rapid way to identify which infections cause the symptoms. It can be used anywhere and anytime by yourself.



Get result at home



Easy self-testing



Time-saving

Anytime, Anywhere, Test by yourself !



Hospital



Test Site



Airport



Station



Hotel



Corporation



Mass Screening

HAVE YOU EVER HAD SUCH CONCERNS?

Worried about inconvenient to test

- No hospitals or test site available nearby.
- Physical discomfort, queue for a long time to test.

Worried about can not get result immediately

- Long time waiting for a PCR test result.
- Want to know the result immediately.

Worried about the family

- Anyone in my family been infected?
- How to test elder and infants?

Worried about infection

- Infection risk in crowded hospitals or test site.
- If there are close contacts around you?



Let us
SOLVE
your troubles!

It can detect mutated virus

High accuracy detection $\geq 96\%$

- ✓ Test result is available in 8 minutes.
- ✓ Self-testing is convenient at home, or anywhere else.
- ✓ Risk control for easy life and working.
- ✓ Shelf-life of 1.5 years, you can store for a long time.

Easy detection will make you feel ease, people around you also feel comfortable.

Simple steps, easy-handling for anybody!

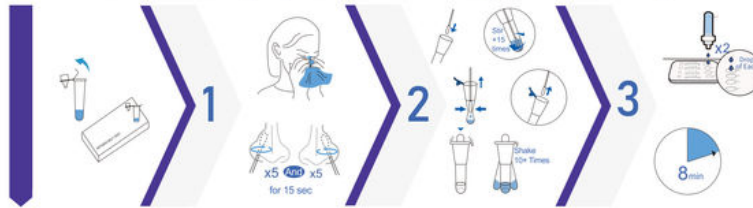

Result Reading

For Cov & Rsv

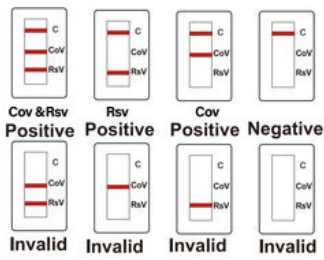

For MP & ADV & HMPV

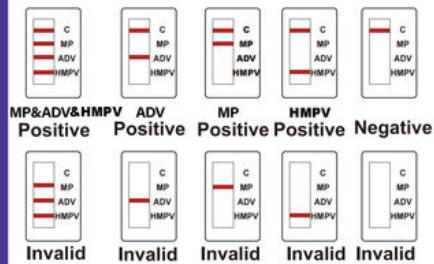

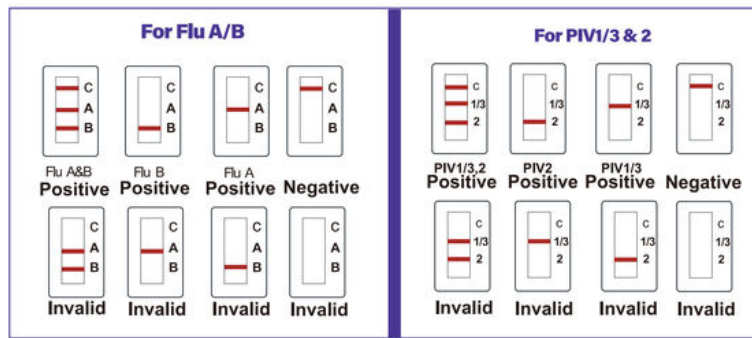

Shipping Details



CB	
QTY :	360 PCS
G.W :	14 KG
MEAS :	46X44X44CM

IFU 9 in 1

多病原體病毒原體聯合測試盒
 基於化學式乙型肝炎病毒表面抗原
 肺炎支原體病毒原體測試盒(1/2型) / 肺結核菌

第 1 步: 準備測試

1. 取出試管
 取出試管後，將試管蓋蓋緊，並將其放入試管架中。

2. 取出拭子
 取出拭子後，將拭子放入試管中，並將其蓋蓋緊。

3. 從患者鼻孔收集樣本
 將拭子插入患者鼻孔，並輕輕旋轉，以收集樣本。

4. 取出拭子
 取出拭子後，將拭子放入試管中，並將其蓋蓋緊。

5. 取出拭子
 取出拭子後，將拭子放入試管中，並將其蓋蓋緊。

6. 取出拭子
 取出拭子後，將拭子放入試管中，並將其蓋蓋緊。

7. 取出拭子
 取出拭子後，將拭子放入試管中，並將其蓋蓋緊。

9 in 1

多病原體病毒原體聯合測試盒
 基於化學式乙型肝炎病毒表面抗原
 肺炎支原體病毒原體測試盒(1/2型) / 肺結核菌

第 2 步: 收集樣本

1. 取出拭子
 取出拭子後，將拭子放入試管中，並將其蓋蓋緊。

2. 取出拭子
 取出拭子後，將拭子放入試管中，並將其蓋蓋緊。

3. 取出拭子
 取出拭子後，將拭子放入試管中，並將其蓋蓋緊。

4. 取出拭子
 取出拭子後，將拭子放入試管中，並將其蓋蓋緊。

5. 取出拭子
 取出拭子後，將拭子放入試管中，並將其蓋蓋緊。

6. 取出拭子
 取出拭子後，將拭子放入試管中，並將其蓋蓋緊。

7. 取出拭子
 取出拭子後，將拭子放入試管中，並將其蓋蓋緊。

9 in 1

多病原體病毒原體聯合測試盒
 基於化學式乙型肝炎病毒表面抗原
 肺炎支原體病毒原體測試盒(1/2型) / 肺結核菌

第 3 步: 讀取結果

1. 取出拭子
 取出拭子後，將拭子放入試管中，並將其蓋蓋緊。

2. 取出拭子
 取出拭子後，將拭子放入試管中，並將其蓋蓋緊。

3. 取出拭子
 取出拭子後，將拭子放入試管中，並將其蓋蓋緊。

4. 取出拭子
 取出拭子後，將拭子放入試管中，並將其蓋蓋緊。

5. 取出拭子
 取出拭子後，將拭子放入試管中，並將其蓋蓋緊。

6. 取出拭子
 取出拭子後，將拭子放入試管中，並將其蓋蓋緊。

7. 取出拭子
 取出拭子後，將拭子放入試管中，並將其蓋蓋緊。

9 in 1

多病原體病毒原體聯合測試盒
 基於化學式乙型肝炎病毒表面抗原
 肺炎支原體病毒原體測試盒(1/2型) / 肺結核菌

第 4 步: 讀取結果

1. 取出拭子
 取出拭子後，將拭子放入試管中，並將其蓋蓋緊。

2. 取出拭子
 取出拭子後，將拭子放入試管中，並將其蓋蓋緊。

3. 取出拭子
 取出拭子後，將拭子放入試管中，並將其蓋蓋緊。

4. 取出拭子
 取出拭子後，將拭子放入試管中，並將其蓋蓋緊。

5. 取出拭子
 取出拭子後，將拭子放入試管中，並將其蓋蓋緊。

6. 取出拭子
 取出拭子後，將拭子放入試管中，並將其蓋蓋緊。

7. 取出拭子
 取出拭子後，將拭子放入試管中，並將其蓋蓋緊。